

# Ductware

## F1 Hi-Temp / F2 Grease Duct Sandwich<sup>®</sup> Access Panels

By Ductmate



## F1 (538°C) & F2 (1,260°C) Access Panels

### For Grease Duct OR High-Temperature Applications

- 16 GA black iron backing plate with smooth interior
- No measuring necessary (self-adhesive template provided)
- Available in all standard sizes for flat and round duct access doors
- No frame to install and seal
- Available in aluminized, black iron, and stainless steel 304 & 316
- Effortless opening and closing: no special tools required
- Zinc plated carriage bolts are secured to the inner plate

**Ductware<sup>®</sup>**  
Productivity solutions with green results

# F1 & F2 Access Panels

**Sandwich®  
Access Panels**

## DESCRIPTION

The F1 Hi-Temp Sandwich Access Panel is for high temperature duct applications. Its fiberglass rope gasket allows its use with temperatures up to 538°C.

The F2 Grease Duct Access Panel is for grease duct applications. Its ceramic fiber gasket allows its use with temperatures up to 1260°C. The F2 Access Panel meets NFPA96 standards. **Please specify when ordering the F2 rectangular panel for use with a duct fire wrap system--longer bolts will be provided.**

## BASIC USE

To provide easy access into high-temperature duct or grease duct. Access panel application approval resides with the authority having jurisdiction.

## INSTALLATION

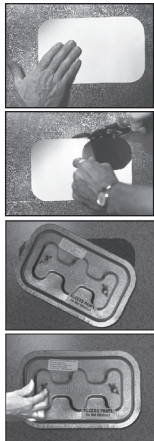

1. Peel backing from template and apply to ductwork in desired location.
2. Opening can be cut with a hand-held plasma cutter or by conventional methods.
3. Insert door into opening at an angle and tighten wing nuts.
4. Do not over-tighten wing nuts. Gasket insures an airtight seal.

## LIMITED PRODUCT WARRANTY

Ductmate warrants that the F1 & F2 Access Panels, when properly installed and maintained, will be free from defects in material and workmanship, and will comply with all written specifications made by Ductmate at the time of sale. Ductmate's warranty shall run for a period of one year from the date of manufacture.

**Warranty Limitation:** The warranty stated above is in lieu of all other warranties, express or implied, including but not limited to the implied warranties of MERCHANTABILITY AND FITNESS FOR A PARTICULAR PURPOSE. Although Ductmate may have suggested the product, or provided written or oral advice to the Purchaser, it is the Purchaser's responsibility to test and determine the suitability of F1 & F2 Access Panels, for the intended use and purpose, and Purchaser and/or its customer assumes all risk and liability whatsoever regarding such suitability.

**Limitation of Liability:** In the event of a breach of the above warranty, Ductmate's sole obligation, and Purchaser's sole and exclusive remedy, shall be, at Ductmate's option, repair or replacement of any defective products, or refund of an applicable portion of the purchase price. Ductmate shall have no liability for costs of removal or re-installation of the product. The Purchaser agrees that no other remedy, including but not limited to loss of profits, loss sales, injury to person or property, or any other special, incidental or consequential damages, shall be available to the Purchaser for any claim arising out of this Agreement, regardless of whether such claim is made in contract or in tort, including strict liability in tort. In no event will Ductmate be obligated to pay damages to the Purchaser in any amount exceeding the purchase price that the Purchaser paid to Ductmate for the allegedly defective product.

## COMPOSITION & MATERIALS

### a. Gasket

The F1 Access Panel's fiberglass rope gasket is permanently bonded to the outside panel of the access panel to eliminate leakage.

The F2 Access Panel's ceramic fiber gasket is permanently bonded to the outside panel of the access panel to eliminate leakage. The ceramic fiber gasket meets NFPA 96 standards.

### b. Steel Panels

The F1 and F2 Access Panels consist of two layers of precision stamped, hot-dipped galvanized steel that "sandwich" the duct wall.

### c. Black Iron Backing Plate

The smooth 16GA black iron backing plate is spot welded to the inside panel.

### d. Springs

Zinc plated conical springs are installed over the bolts, between the inner and outer panel, to facilitate opening

### e. Wing Nuts

Zinc coated wing nuts are easily turned by hand without tools.

### f. Bolts

Zinc plated carriage bolts are secured to the inner door.

### g. Template

Self-adhesive cut-around template is provided for the exact size of duct opening required.

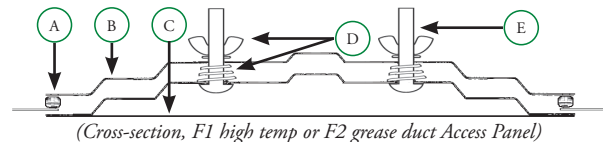

## ACCESS PANEL SIZES

Rectangular Duct Panel Sizes (mm) †	
*203 x 102	457 x 356
254 x 152	*406 x 305
305 x 203	*610 x 457
*panel is oval-shaped	

Round Duct Door Sizes: †‡	
Door Size (mm)	Fits Duct Diameter (mm)
203 x 102	127 - 356
305 x 203	254 - 508
406 x 305	381 - 914
610 x 457	737 - 3658
† Specify F1 or F2 Access Panel when ordering ‡ Specify actual duct diameter when ordering	

**Ductware®**  
Productivity solutions with green results

AUSTRALIA: 1300 DUCTWARE(3828 9273)

NZ:+64 07 571 5467

[www.ductware.com.au](http://www.ductware.com.au)

[sales@ductware.com.au](mailto:sales@ductware.com.au)